



# JOTUN

## Bringing freedom to texture



**Reveal Sand**

Technology made for you

**Powder Coatings**

Industrial

Jotun GreenSteps 

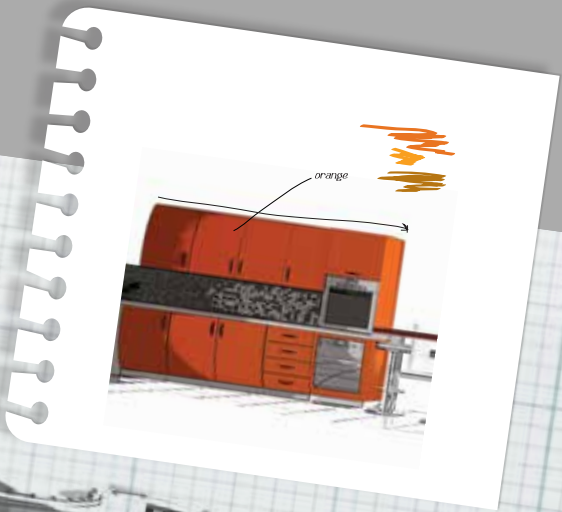

## Bringing MDF to life

Reveal Sand brings to life any design concept regardless of shape or size. It delivers a host of benefits in one product:

- Able to coat both the back and front of MDF boards at once
- Environmentally friendly (VOC free)
- Flexible to work with any shape
- Wide range of colours
- Freedom of design
- Excellent colour stability

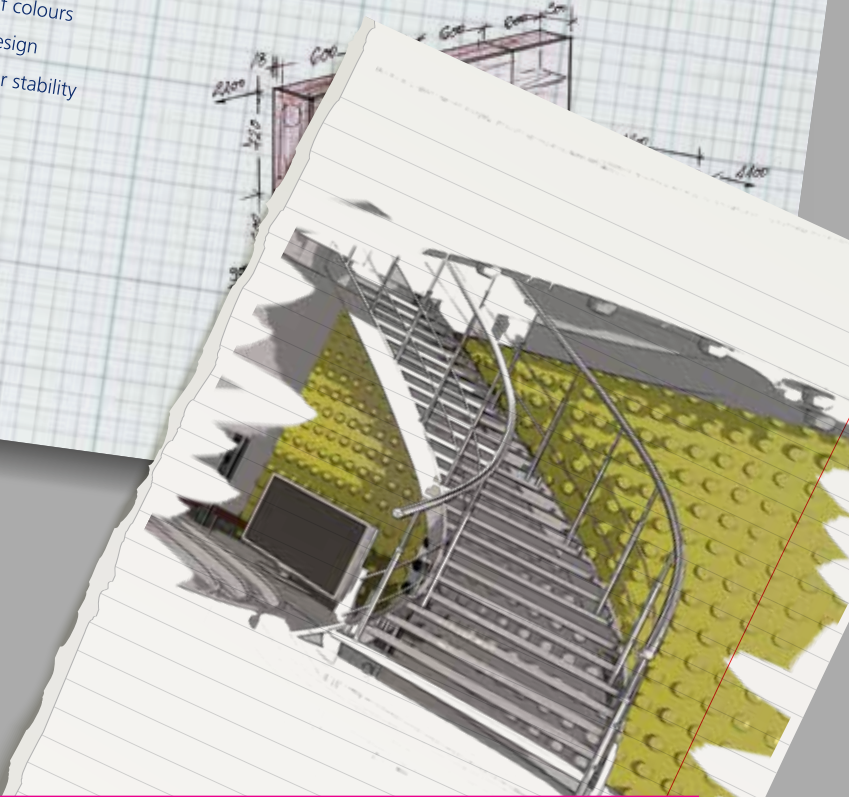
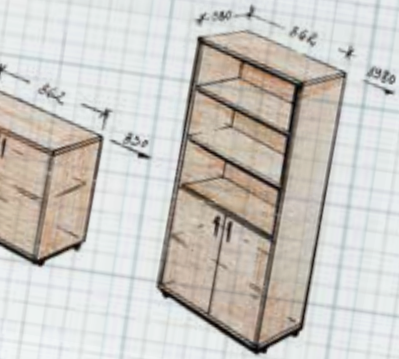

# Created with freedom in mind

---

We understand how important freedom is for designers and furniture craftsmen to produce new and intriguing designs. At Jotun, we aim to make finishes that both compliment your designs and protect the materials used.

That's why we created Reveal Sand, our new powder coating solution specially created for heat sensitive substrates such as MDF. In addition to providing protection, Reveal Sand is also resistant to scratches, water stains and impact, meeting all the requirements of the furniture industry.

From office furniture to retail displays, doors, countertops, kitchen cabinets and more, MDF is an ideal material to build with. Reveal Sand offers the perfect partnership, providing a finish that works with any shape and is available in a wide range of colours.

---

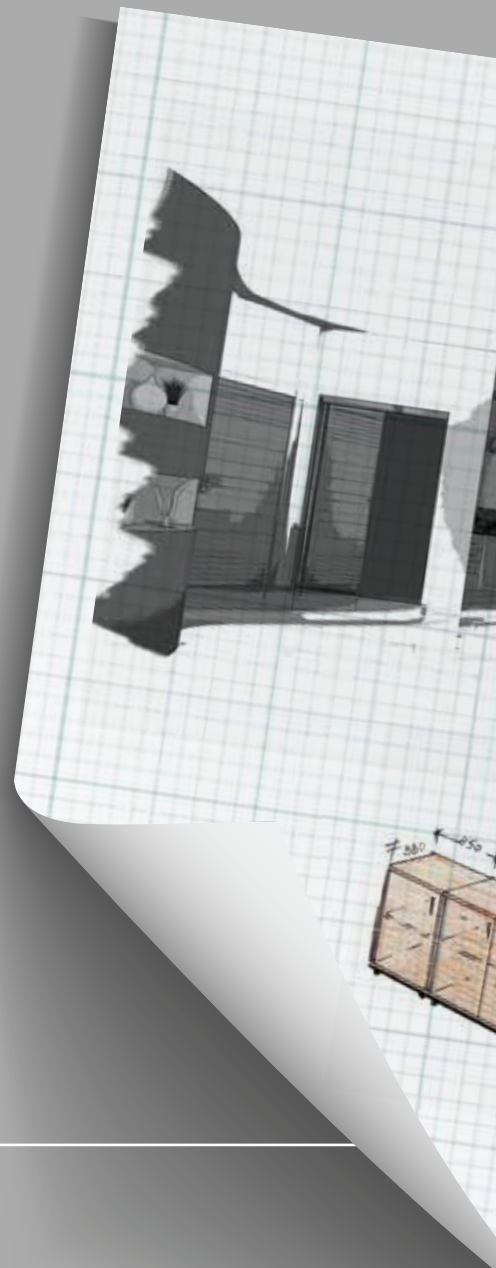



# Bringing unlimited design opportunities with MDF

You can dream big and bring your imagination to life knowing that Reveal Sand provides a stunning, long-lasting finish to all shapes.

The flexible nature of the product allows you to coat anything from elegant contoured edge profiles to stylish curvilinear shapes, while maintaining a strong surface that will stand the test of time.

## Product features

Reveal Sand offers a host of benefits to industrial designers, furniture craftsmen, applicators and end users:

		Designers	Furniture Makers	Applicators	End Users
Texture		X	X	X	X
A wide gloss range (from 5 to 30±5 – Gloss at 60° viewing angle)		X	X	X	X
Extensive range of colours		X	X	X	X
Superior chemical and surface resistance		X	X	X	X
Increased operational productivity			X	X	
Freedom of design		X	X	X	X
All sides of substrate including edges, coated simultaneously		X	X	X	X
Reduced sanding requirement			X	X	
Environment	No VOC	X	X	X	X
	Low carbon footprint	X	X	X	X
	Low eco-footprint	X	X	X	X
	Minimising waste	X	X	X	X

# What your technical team needs to know

## ■ MDF Preparation and Use

MDF is the engineered-wood based material of choice for powder coating as it has a low porosity and a homogeneous surface that readily accepts the powder.

As MDF is an organic substrate, the MDF grade performances and characteristics must be controlled to achieve successful powder coating. In particular, density profile, moisture content, composition, internal bond strength, surface smoothness, sandability, outgassing and temperature behaviour at curing temperatures have to be taken into account.

The MDF surface must be clean and free from dust and loose MDF fibres. Sanding of the surface and the edges may be required. Further we recommend a proper quality control of MDF prior and post coating to ensure long lasting performance.



## ■ Application Line

Unlike aluminium and steel, MDF has by nature a very low electrical conductivity. Our long experience in MDF powder coatings enables us to help you set the right application parameters to compensate for this lack of natural electrical conductivity and gives you the opportunity to buy a wide range of suitable MDF boards.

## ■ Curing Process

In the curing process, IR heating or a combination of IR and convection is recommended. It is essential that a complete cure of the film takes place, since only a properly cured film can support MDF board dimension variation due to moisture uptake during its lifespan.

## ■ Colour

For your special colour requirements and an accurate colour assessment, please contact your nearest Jotun Powder Coatings representative who will be happy to provide you with a sample panel.

## A Jotun GreenSteps Product

This product isn't just a step towards outstanding protection for your property; it is also a step towards a better environment. It is one of many Jotun products that qualifies to be a part of the Jotun GreenSteps programme – a programme that makes a significant difference to the world we all share, with steps like waste and hazardous material reduction, product innovations that reduce energy usage, new processes that lower our carbon footprint and creating more products with lower Volatile Organic Compound (VOC) emissions. By using this Jotun GreenSteps product, you are part of a journey to a greener, more colourful world.

## Environmental benefits of Powder Coatings

Environmentally friendly, powder coatings do not contain solvents, so no VOCs are released into the air. Unused or oversprayed powder can be recycled with minimal wastage, and disposal is easy and safe. In addition, all Jotun Powder Coatings' products are lead-free.





## About Jotun

---

Jotun is one of the world's leading manufacturers of decorative paints, marine, protective and powder coatings. The group has 74 companies and 39 production facilities on all continents. Jotun products are available in 90 countries through own subsidiaries, joint ventures, agents, branch offices and distributors. At Jotun Powder Coatings, we are committed to develop, produce and deliver solutions that create value through consistency in application, enhanced appearance and superior durability.

## Stay in touch

---

Please contact us for more information on our product range. We offer company training on our product portfolio and powder coating technology through a number of powder schools that we run for selective customers. Feel free to contact your local sales representative for more information.



Scan QR code to find out more or visit [jotun.com](https://www.jotun.com)



Jotun Protects Property



# Textured finish, smaller carbon footprint

Industries around the world are under increasing pressure to reduce their CO<sub>2</sub> emissions, and in so doing decrease their contribution to global warming. By using our low cure powder coating, Reveal Sand, you are able to significantly decrease your CO<sub>2</sub> emissions when compared to other technologies.

Looking from a broader perspective, even the eco-footprint for a low cure powder is much smaller compared to other technologies.

## CARBON FOOTPRINT\*

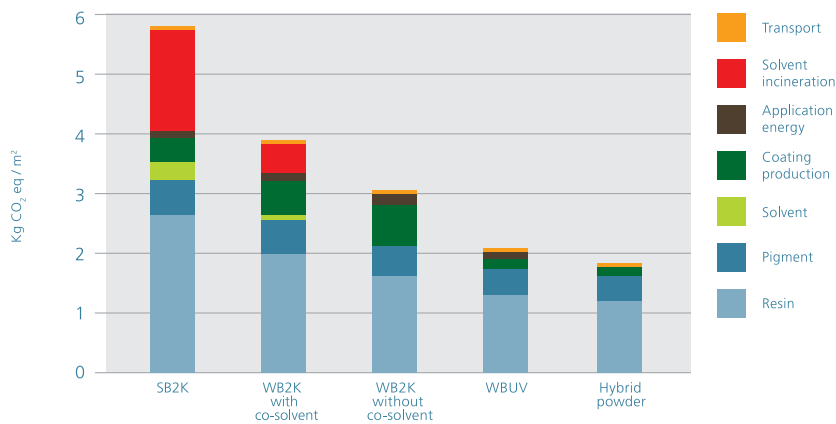

1m<sup>2</sup> coated MDF –Thickness: 150 microns  
 \*Cradle-to-gate carbon footprint assessment - partial product life cycle from resource extraction to the factory gate exit.  
 Courtesy of DSM

## ECO-FOOTPRINT\*

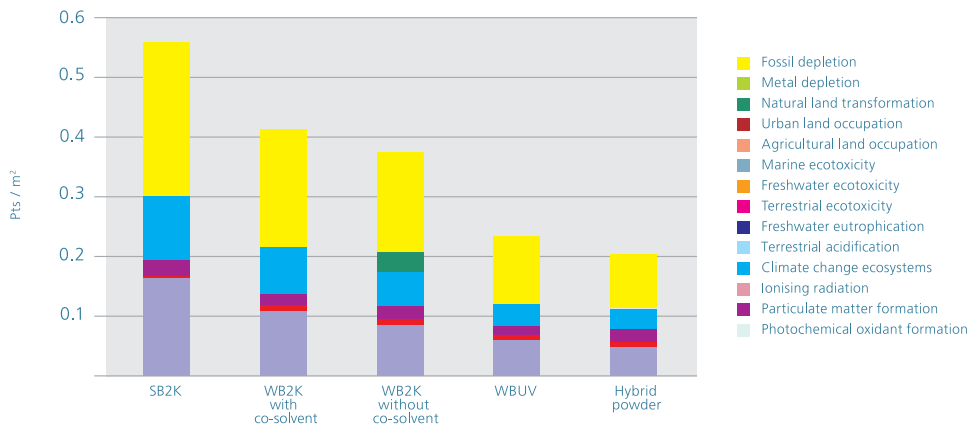

1m<sup>2</sup> coated MDF –Thickness: 150 microns  
 \*Cradle-to-gate eco-footprint assessment - partial product life cycle from resource extraction to the factory gate exit.  
 Courtesy of DSM

# Product description

Product name	Examples of application areas	Curing schedule (dependent on curing oven and substrate)	Gloss (60°) ISO 2823	Finish	Colours	Chemical resistance
Reveal Base	All types of MDF/HDF furniture: office and home furniture, kitchen cabinets, nursery furniture, retail displays and shelving, partitioning, cabinet enclosures, doors, counter tops, etc.	140°C – 3 to 8 minutes	NA	Even Surface	Light and Dark	Very good
Reveal Sand	All types of MDF/HDF furniture: office and home furniture, kitchen cabinets, nursery furniture, retail displays and shelving, partitioning, cabinet enclosures, doors, counter tops, etc.	140°C – 5 to 8 minutes	5 – 30 (+/-5)	Texture	Extensive range of colours	Very good

When used together, Reveal Sand as a top coat, and Reveal Base, as a primer/sealer, the total curing schedule used to cure both layers can be minimised. Indeed, the first layer does not need to be entirely cured before the second layer is being applied. A 3-minute cure for example of the first layer followed by another 8-minute cure when the second layer is applied is usually enough to have the total system cured and have the MDF benefit from a proper sealing and finish.

Temp Cure: 140°C	Suggested curing time	▶▶	11 minutes
Reveal Base	3 minutes		
Reveal Sand	8 minutes		

# Performance

Reveal Sand scores highly in a wide-ranging series of performance tests.

The technical data provided below are typical for Reveal Sand applied to 18 mm MDF board (130-160 µm film thickness). Typical values when tested have not necessarily been recently revised. Values may vary with colour and gloss level.

Description	Norm	Reveal Sand
Hardness	ASTM 3363-05	F-H
Adhesion	EN ISO 2409 – 2mm	GT 0
Abrasion Resistance	DIN 68861-2	2C
Scratch Resistance	DIN 68861-4	4B
Dry Heat Resistance	DIN 68861-7	7A
Wet Heat Resistance	DIN 68861-8	8A
Chemical Resistance	DIN 68861-1	1B